

# Non-invasive breath analysis for the detection of gastrointestinal disorders with the Gastrolyzer® range



CE  
2797



*Helping to detect gastrointestinal disorders, one breath at a time.*

[www.bedfont.com](http://www.bedfont.com)





# Contents

Hydrogen Breath Testing (HBT)	4
The role of Methane alongside hydrogen breath testing (HMBT)	5
Gastro <sup>+</sup> ™ Gastrolyzer®	6
Face mask sampling system	7
Mouthpiece sampling system	7
Gastro <sup>+</sup> ™ features and benefits	8
Gastro <sup>+</sup> ™ technical specification	8
Gastro <sup>+</sup> ™ consumables	9
GastroCH <sub>4</sub> ECK® Gastrolyzer® features	10
GastroCH <sub>4</sub> ECK® Gastrolyzer®	11
GastroCH <sub>4</sub> ECK® features and benefits	11
GastroCH <sub>4</sub> ECK® technical specification	12
GastroCH <sub>4</sub> ECK® consumables	13
GastroCHART™ patient database	14
References	14
Gastrolyzer® forum	15

## Hydrogen Breath Testing (HBT)

HBT is a non-invasive, and specific means of diagnosing small bowel sugar malabsorption. HBT makes use of gut bacteria's ability to digest sugars and convert these to hydrogen, which is then absorbed into the blood and can be measured in exhaled breath<sup>1</sup>.

The test is commonly used in paediatric and adult gastroenterology departments to diagnose malabsorption of the sugars lactose, fructose and sucrose. It is also used to investigate small intestinal bacterial overgrowth (SIBO)<sup>2</sup>.

The Gastrolzyer® range is world renowned for delivering accurate hydrogen breath testing, cited by clinical leaders in gastroenterology, such as Robert Heuschkel<sup>3</sup> and Way Seah Lee<sup>4</sup>.



## The role of Methane alongside Hydrogen Breath Testing (HMBT)

A percentage of patients do not produce hydrogen and therefore would not be diagnosed by the use of HBT alone. The role of GastroCH<sub>4</sub>ECK® is to ensure that patients who are non-hydrogen producers, but produce methane or a combination of both, are not misdiagnosed.

**“Medical literature shows that the level of methane producers varies by gender and population group, from approximately 33-41%<sup>5,6,7</sup>”**

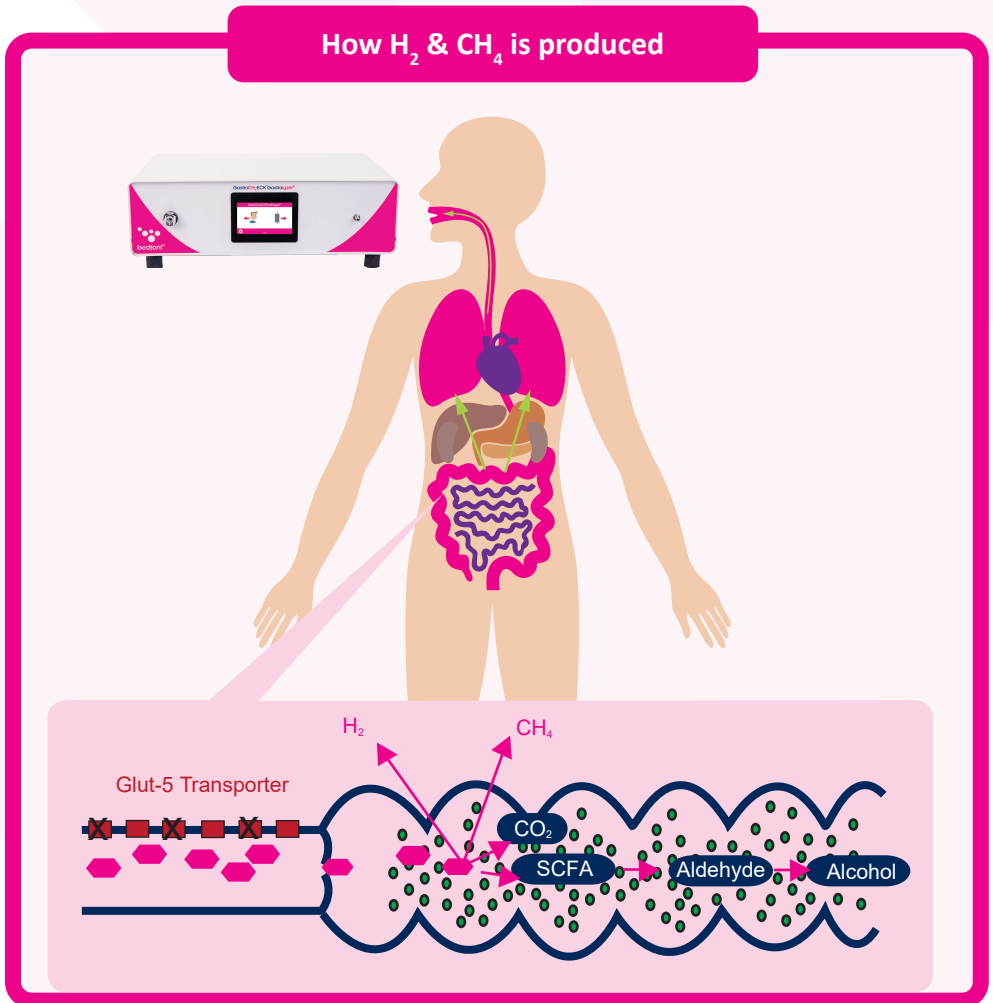

Portable breath Hydrogen monitoring to help diagnose gastrointestinal disorders.



Aids in the detection of:

Food intolerances

Irritable Bowel Syndrome (IBS)

Small Intestinal Bacterial Overgrowth (SIBO)

**FREE**  
GastroCHART™  
software

**Ideal for:**

- Gastroenterologists
- Gastro paediatricians
- Dieticians
- GP's
- Endoscopy departments



Multiple patient testing



Create and save patient details

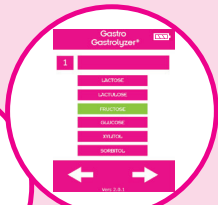

Built in testing protocol

The easy to use, complete breath Hydrogen monitor with 2 sampling modes.

### Face mask sampling system

This sampling system is recommended for use with younger or older patients who are unable to cooperate with the test. The Gastro<sup>+</sup>™ is attached to a face mask, which is then placed over the mouth and nose of the patient. Once 'face mask' mode is selected, the Gastro<sup>+</sup>™ will take a real-time reading until the result stabilises. The reading is then held on the screen and can then be saved to a patient profile, downloaded to the GastroCHART™ database or recorded manually.



### Mouthpiece sampling system

This sampling system is recommended for use with adults or patients able to hold their breath for a short period of time. The patient takes a deep breath in, holds, then exhales slowly through a mouthpiece. Within 45 seconds their result will be displayed on the screen and can then be saved to a patient profile, downloaded to the GastroCHART™ database or recorded manually.



## Features and benefits

- Easy to use interface
- Maintenance reminders
- Only needs calibrating quarterly
- Create and store patient details
- Multiple patient testing
- Built in testing protocols with built in countdown timer
- Large touchscreen
- SteriTouch® technology for improved infection control
- Comes with GastroCHART™ software



## Technical Specification:

Concentration range	0-500ppm
Display	Full colour touchscreen
Detection principle	Electrochemical sensor
Repeatability	<5%
Accuracy	≤±3ppm/10% - whichever is greater*
Power	3 x AA (LR6 or equivalent) – up to 1000 minutes 1 x CR2032 Lithium coin cell
T <sub>90</sub> response time	<40 seconds
Operating temperature	15-35°C
Storage/transport temperature	0-50°C
Operating/storage/transport pressure	Atmospheric ±10%
Operating humidity	15-90% non-condensing
Storage/transport humidity	0-95%
Sensor operating life	2 years
Sensor sensitivity	1ppm
Sensor drift	<2% per month
Dimensions	Approx. 37 x 77 x 140mm
Weight	Approx. 215g (including batteries)
Materials	Case: polycarbonate/ABS blend SteriTouch® anti-microbial additive D-piece™: polypropylene SteriBreath™ Eco : paper OneBreath Mouthpiece: polypropylene
CO cross interference	<4%

\* Readings of >200ppm at temperature between 26-35°C can decrease accuracy to 15%.



## Consumables

**SteriBreath™ Eco mouthpiece:** SteriBreath™ Eco mouthpiece is entirely made from paper and therefore it is 100% recyclable and 100% biodegradable, including its packaging. Even better, all the materials are from sustainable sources.



**Order code:** STERIBREATH-ECO (250 per box)

**D-piece™:** The D-piece™ is used to attach a SteriBreath™ mouthpiece to the monitor. The D-piece™ incorporates a one-way valve and an infection control filter, which are proven to remove and trap >99% of airborne bacteria and >97% of viruses<sup>8</sup>. The D-piece™ should be changed every four weeks, an automatic reminder will appear on the screen every 28 days.



**Order code:** D-PIECE-3 (12 per box)

**OneBreath™ mouthpieces:** The OneBreath™ mouthpiece is a single-use bacterial filter mouthpiece and can be attached directly to the monitor to take a breath sample. The OneBreath™ incorporates a one-way valve and an infection control filter, which are proven to remove and trap >99% of airborne bacteria and <97% of viruses<sup>8</sup>.



**Order code:** ONEBREATH-MP (250 per box)

**Face mask sampling system:** This sampling system is single patent use and allows the patient to breathe normally through a face mask in order to produce a breath sample.



**Order code:** ISSA-V-2 (1 sampling kit)

### Small face mask

Suitable for use with infants. **Order code:** EC60-IM-V

### Medium face mask

Suitable for use with adolescent. **Order code:** EC60-MM-V

### Large face mask

Suitable for use with adults. **Order code:** EC60-AM-V



**Monitor cleaning wipes:** Free from alcohol to ensure continued performance of your monitor. Products containing alcohol cannot be used on any of the Gastrolyzer® range.



**Order code:** WIPE-V (pack of 50)

**Calibration kit:** The Gastro™ requires calibration quarterly using 100ppm H<sub>2</sub> gas, provided as a kit or replacement cylinder.

**Order code:** 012-14-12010K-V (kit)

012-14-12010-V (replacement cylinder)



## GastroCH<sub>4</sub>ECK® Gastrolyzer® features

Accurate and real-time combined CH<sub>4</sub>, H<sub>2</sub>, and O<sub>2</sub> monitoring.

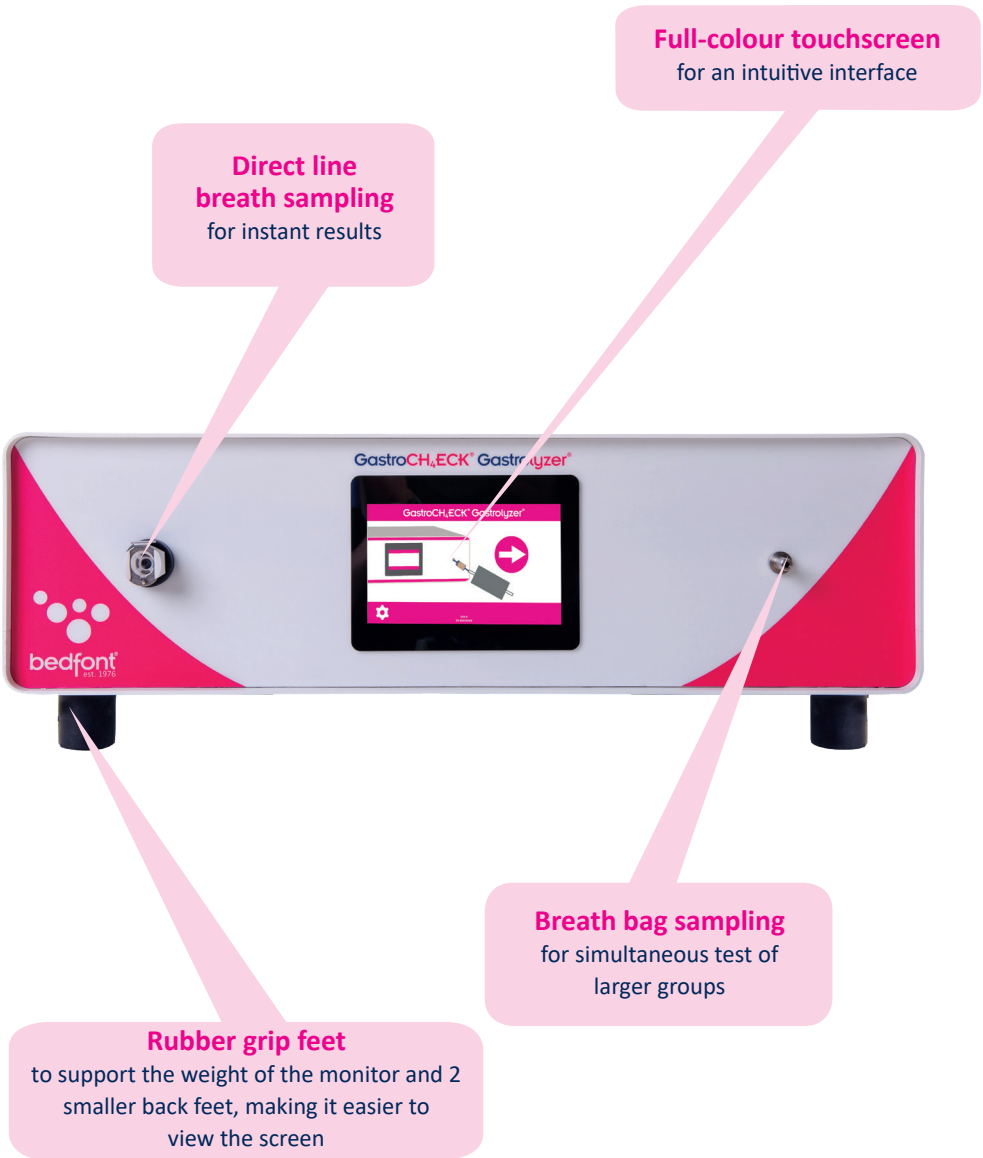

# GastroCH<sub>4</sub>ECK® Gastrolyzer®

## ***Hydrogen and methane monitoring to aid in the diagnosis of gastrointestinal disorders.***

The GastroCH<sub>4</sub>ECK® is a portable breath CH<sub>4</sub>, H<sub>2</sub> and O<sub>2</sub> monitor, which allows health professionals to accurately detect a range of gastrointestinal disorders. An O<sub>2</sub> reading is taken to motivate patients to provide an end-tidal sample. If the sample is not adequate the GastroCH<sub>4</sub>ECK® will automatically correct the reading saving the patient from embarrassment and eliminates the need to carry out another test.

### **Applications**

**The GastroCH<sub>4</sub>ECK® can be used as an aid to diagnose the following disorders:**

- Carbohydrate breakdown deficiency
- Carbohydrate malabsorption
- Lactose intolerance
- Bacterial overgrowth
- Determination of time passage through gut
- Irritable bowel syndrome (IBS)

### **Features/benefits**

- Direct breath sampling line for instant results
- Breath bag sampling for simultaneous testing of larger groups
- Requires calibration just once a month, saving time and calibration gas costs
- Full-colour touchscreen
- Intuitive interface
- No warm-up time
- Maintenance reminders
- Service diagnostic management
- FREE GastroCHART™

**“Medical literature shows that the level of methane producers varies by gender and population group from approximately 33-41%<sup>5,6,7</sup>”**

**“If you are serious about providing a gold-standard breath testing service, the Bedfont® GastroCH<sub>4</sub>ECK® system is essential, as without methane monitoring you will be missing very important clinical information and increase your percentage of false negative tests. It is also very important to map patients symptoms prior to and during the test to make sure the clinical translation of the physiological findings are maximised.”**

Dr Anthony Hobson from The Functional Gut Clinic, London, UK.

## GastroCH<sub>4</sub>ECK® Technical Specification:

Concentration range	CH <sub>4</sub>	0-200ppm	
	H <sub>2</sub>	0-200ppm	
	O <sub>2</sub>	14-23%	
Power input	230V/100V, 50Hz-60Hz, 0.5-1.0 A		
Fuse	T 3.15 AH		
Calibration frequency	Every 4 weeks		
Start-up time	≤2 minutes		
Display	Full colour touchscreen		
Detection principle	Electrochemical sensor (O <sub>2</sub> & H <sub>2</sub> ) Laser (CH <sub>4</sub> )		
Accuracy	CH <sub>4</sub>	Resolution	1ppm
		Accuracy	±10% of reading
		Repeatability	<5% difference on consecutive readings
	H <sub>2</sub>	Resolution	1ppm
		Accuracy	±10% of reading
		Repeatability	<5% difference on consecutive readings
	O <sub>2</sub>	Resolution	0.1%
		Accuracy	±10% of reading
		Repeatability	<5% difference on consecutive readings
Carbon monoxide cross-sensitivity (H <sub>2</sub> only)	<4%		
Temperature range	Operating	15-35°C (59°-95°F)	
	Storage	0-40°C (32°-104°F)	
Pressure range	Operating	912-1114mbar (Atmospheric ±10%)	
	Storage	912-1114mbar (Atmospheric ±10%)	
Humidity range	Operating	30-75% RH (non-condensing)	
	Storage	15-90% RH (non-condensing)	
Sensor operating life	CH <sub>4</sub>	5 years	
	H <sub>2</sub>	2 years	
	O <sub>2</sub>	2 years	
Dimensions	Approx. 474 x 310 x 135 mm		
Weight	Approx. 8.5kg		
Monitor construction	Case: aluminium		
Classification	Class I ME equipment: (externally powered) Type BF applied part Method of sterilization (not suitable for sterilization) Not suitable for use in an oxygen rich environment Intended for continuous use		
Response time	≤45 seconds		
Warranty	2 years*		

\* Subject to maintenance and service.

## GastroCH<sub>4</sub>ECK® Consumables

**GastroCH<sub>4</sub>ECK® mouthpieces:** specifically designed with the latest moisture removal and bacterial filtration to remove 99.9% of airborne bacteria from the patient's breath<sup>8</sup>. GastroCH<sub>4</sub>ECK® mouthpieces are 'per patient use' so can be used for the duration of a patients testing procedure and disposed of. **DO NOT REUSE AFTER THE 1<sup>ST</sup> DAY OF TESTING.**



**Order code:** GASTROCHECK-MP-XL (box of 250)

**GastroCH<sub>4</sub>ECK® breath bags:** specifically designed to capture as much end-tidal air as possible, with a one-way mouthpiece to prevent loss of sample. GastroCH<sub>4</sub>ECK® breath bags are 'per patient use' so can be used for the duration of a patients testing procedure and disposed of. **DO NOT REUSE AFTER THE 1<sup>ST</sup> DAY OF TESTING.**



**Order code:** GASTROCHECK-BAG-XL (250 breath bags and bag mouthpieces)

**Face mask sampling system:** this sampling system is single patient use and allows the patient to breathe normally through a face mask in order to produce a breath sample. For use with breath bags.



**Order code:** ISSA-BB (1 sampling kit)

### Small face mask

Suitable for use with infants. **Order code: EC60-IM-V**

### Medium face mask

Suitable for use with adolescent. **Order code: EC60-MM-V**

### Large face mask

Suitable for use with adults. **Order code: EC60-AM-V**



**Moisture removal filters:** for use with the breath bag sampling mode. These will last for approximately 150 samples and need to be changed when the filter changes from orange to dark green.



**Order code:** GASTROCHECK-DESS-XL (pack of 5 moisture removal filters)

**Calibration kit:** the GastroCH<sub>4</sub>ECK® requires calibration once per month using 100ppm H<sub>2</sub>, 100ppm CH<sub>4</sub> & 20.9% air provided as a kit or replacement cylinder.

**Order code:** GASTROCHECK-CAL-KIT  
GASTROCHECK-CAL -(Replacement cylinder)



# GastroCHART™ patient database (included with every Gastro+™ & GastroCH<sub>4</sub>ECK®)

The GastroCHART™ is designed specifically for use with the Gastro+™ and GastroCH<sub>4</sub>ECK®. With the Gastro+™, the software is integrated and allows the health professionals to save up to 10 patients on the monitor for satellite breath tests. If the Gastro+™ or GastroCH<sub>4</sub>ECK® are connected to a PC, readings can be downloaded to an unlimited patient database immediately. The readings can then be shown in tabular format or in a graph to show whether the patient has presented a positive/negative result. Results can be easily printed for the patient to retain and for record in their medical history.



## References

1. Ledochowski, M. and Ledochowski, L. (2011) Hydrogen Breath Tests. 2nd Edition edn. Austria: Verlag Akademie für Ernährungsmedizin GmbH.
2. Eisenmann, A., Amann, A., Said, M., Datta, B. and Ledochowski, M. (2008) 'Implementation and interpretation of hydrogen breath tests', *Journal of Breath Research*, 2(4), p.046002.
3. Shelley, H., Brennan, M. and Heuschkel, R. (2009) 'Hydrogen breath testing in children: What is it and why is it performed?', *Gastrointestinal Nursing*, 7(5), pp. 18–27
4. Lee, W., Davidson, G., Moore, D. and Butler, R. (2000) 'Analysis of the breath hydrogen test for carbohydrate malabsorption: Validation of a pocket-sized breath test analyser', *Journal of Paediatrics and Child Health*, 36(4), pp. 340–342.
5. Roccarina, D., Lauritano, E. C., Gabrielli, M., Franceschi, F., Ojetti, V. and Gasbarrini, A. (2010) 'The role of methane in intestinal diseases', *The American Journal of Gastroenterology*, 105(6), pp. 1250–1256.
6. Pitt, P., de Bruijn, K. M., Beeching, M. F., Goldberg, E. and Blendis, L. M. (1980) 'Studies on breath methane: The effect of ethnic origins and lactulose', *Gut*, 21(11), pp. 951–954.
7. Di Stefano, M. and Corazza, G. R. (2009) 'Role of hydrogen and methane breath testing in gastrointestinal diseases', *Digestive and Liver Disease Supplements*, 3(2), pp. 40–43.
8. Public Health England. An Evaluation of Filtration Efficiencies Against Bacterial and Viral Aerosol Challenges Report No. 17/001. London: Public Health England; 2017
9. Public Health England. 091.010 NObreath Accessories Mouthpiece Performance Test Report. London: Public Health England; 2009.

# Join the **Gastrolyzer**<sup>®</sup> forum today

**Did you know purchasing this product entitles you to free membership of the Gastrolyzer<sup>®</sup> email forum...**

What is the Gastrolyzer<sup>®</sup> email forum?

It is an international, invitation only forum where professionals using the Bedfont<sup>®</sup> Gastrolyzer<sup>®</sup> range of monitors can communicate and share knowledge.

There is no cost or obligation to participate but membership is free when you purchase a Bedfont<sup>®</sup> Gastro<sup>+</sup>™ or GastroCH<sub>4</sub>ECK<sup>®</sup> Gastrolyzer<sup>®</sup> - take advantage and join this elite group today!

For more information, please contact [forums@bedfont.com](mailto:forums@bedfont.com).



## How does it work?

Signing up is simple and only requires your full name and email address. We will then contact you for your Gastrolyzer<sup>®</sup> serial number.

Email [forums@bedfont.com](mailto:forums@bedfont.com) for more information.

on 01622 851122 or email [ask@bedfont.com](mailto:ask@bedfont.com)



Contact Bedfont® or one of our worldwide **Gastrolyzer®** distributors for a free demonstration.

[www.bedfont.com](http://www.bedfont.com)  
Tel: +44 (0)1622 851122  
E-mail: [ask@bedfont.com](mailto:ask@bedfont.com)

A full list of our worldwide distributors can be found at  
[www.bedfont.com/distributors/](http://www.bedfont.com/distributors/)

***Our family, innovating health, for yours.***



**Bedfont® Scientific Ltd.**

Station Road, Harrietsham, Maidstone, Kent,  
ME17 1JA, England  
Tel: +44 (0)1622 851122. Fax: +44 (0)1622 854860  
Email: [ask@bedfont.com](mailto:ask@bedfont.com) Web: [www.bedfont.com](http://www.bedfont.com)



**Bedfont® GmbH**

Mitterbachweg 18, 5081, Anif, Austria  
Tel: +43 662 635050 Fax: +43 662 635050-50  
Email: [bedfont-gmbh@bedfont.com](mailto:bedfont-gmbh@bedfont.com)

Issue - 4 December 2020, Part No: MKT151\_AX  
Bedfont® Scientific Limited reserve the right to change or update this literature without prior notice.

Registered in: England and Wales. Registered No: 1289798

